

OLD WOUGHTON

News

The Newsletter of Old Woughton Parish Council



Woughton on the Green Conservation Area

PO Box 7575
Milton Keynes
MK11 9GR

Spring 2023

E: clerk@oldwoughton.org.uk

T: 01908 465811

W: www.oldwoughton.org.uk

Who's Who in the Parish

OLD WUGHTON PARISH COUNCIL

The Parish of Old Woughton is divided into 4 small wards.
Details of your local Councillors are listed below.

Woughton on the Green North



Rob Grindley
Planning, Projects,
Green Spaces, Transport

rgrindley@
oldwoughton.org.uk

Roy Kenyon
Allotments, Finance
& Budget, Projects,
Liaison for Transport

rkenyon@
oldwoughton.org.uk

Phil Nash
Allotments,
Communications,
OWIS/IT, Projects

pnash@
oldwoughton.org.uk

Woughton on the Green South



Ray Brown
Allotments,
Planning, Projects.

rbrown@oldwoughton.org.uk

Charlotte Hall
CHAIR

Finance & Budget,
Planning, Projects Lead, Liaison for Parks Trust,
OWPC Representative - Welfare Trust,
Communications

chall@oldwoughton.org.uk

Woughton Park



**Vanessa
Freeman Gwynn**
VICE CHAIR

Projects,
Liaison for MKC Consultation and Parks Trust,
Communications
vgwynn@oldwoughton.org.uk

Geoff Long

Dog & Litter Bins, Projects, Green Spaces,
Liaison for Canal & River Trust

glong@oldwoughton.org.uk

Passmore



Mary Major

Liaison for Parishes Forum,
Projects, Noticeboards, Finance & Budget

mmajor@oldwoughton.org.uk

**Roshini
Wickramasinghe**
Projects

rwickramasinghe@oldwoughton.org.uk

The Borough of Milton Keynes is divided into larger wards, OWPC is in the Campbell Park and Old Woughton Ward. Your ward councillors are:

Clerk



Vicky Mote

CiLCA QUALIFIED
Finance & Budget, Environment, OWIS/IT, Data
Protection Officer, Responsible Financial Officer
clerk@oldwoughton.org.uk



Charlotte Hall

charlotte.hall@milton-keynes.gov.uk
T. 07885 330797



Nana Oguntola

nana.oguntola@milton-keynes.gov.uk
T. 07478 115668



Paul Trendall

paul.trendall@milton-keynes.gov.uk
T. 07793 080425



Annual Parish Meeting –
20th June 2023 at 6.30pm

**Our Next Parish Council
Meetings Are On Monday:**

15th May 2023 (AGM), 10th July 2023
& 11th September 2023

7.30pm. VENUE: St. Mary's Church

CONTACT US

<https://oldwoughton.org.uk>

01908 465811

clerk@oldwoughton.org.uk

OWPC, PO Box 7575,
Milton Keynes, MK11 9GR



Friends of
Old Woughton PC



Editorial

Welcome to the Spring edition of Old Woughton News, this is always such a lovely time of the year, with the lighter months now very much in evidence and, hopefully, that bitter cold but a distant memory.

This quarter we want to cover a number of important items starting with the announcement of OWPC’s post-consultation Precept opposite and how we use local volunteering opportunities to achieve practical tasks around the parish - like that old favourite litter-picking - to reduce costs.

On pages 4 and 5, we’re very pleased to share with you the outcome of the long-awaited City Council’s review of the Conservation Area and the new features in scope. We also introduce the New Town Heritage Register, which considers those much more recent developments, which mark out the distinctiveness of Milton Keynes.

We see some of the human aspects of that growth on page 6 in the emerging headlines from the 2021 Census – 15% more of us have made the city our home just in the last decade! We also show you the political impact of that with a third MP recommended from the next General Election. Before that, however, there are elections to the City Council in May and we alert you to the Government’s new requirement that you take an approved form of ID with you to the Polling Station - the acceptable documents are covered in the article.

Further change is set out on page 7, where details of the revised waste and recycling collections are shown – these are very significant changes involving multiple wheelie bins per household and you are encouraged to apply to MKCC under its Assisted Collections scheme, if you need help to manoeuvre them all on your own.

On the back page we close with a piece on OWPC’s collaboration with Citizens Advice to bring its surgeries out from CMK into the parish itself. We are pleased at how helpful people found these sessions, so do let us know if you’d like to have more.

Happy Easter!

BUDGET 2023/24 APPROVED

The budget for 2023/24 was approved at the January Parish meeting. It contains an increase of 30% to the precept as we continue the adjustment started last year to no longer subsidise the operational expenditure from reserves, as outlined in the Autumn newsletter. The budget detail and summary can be found on the Finance page of the website at <https://oldwoughton.org.uk/parish-council/finance/>.



The Chair

OLD WOUGHTON PARISH COUNCIL

Ever shifting sands...

As I sat down to put pen to paper, I pulled from my bookshelf a copy of our Spring edition 2022 for a moment’s reflection.....

... Gosh how I was struck by where we find ourselves at this time and the rapidity of events and changes that have played out on our own doorsteps in just a few months.

Whilst uncertainty continues to permeate our lives in many different ways, as a Parish Council we continue to work hard to deliver a considered and rounded service for our residents. It is at this time we have set our budget for the forthcoming year and are required to submit our Precept decisions for 2023/2024 to MK City Council. The increase of 63p per month (Band D) continues our long term plan and rhetoric of the need for us as a Council to not be reliant on decreasing reserves to cover our basic costs and to allow us to be best placed to respond to changing governance and growing responsibilities. Whilst the City Council may make overarching decisions, it is increasingly up to local councils and many other volunteer bodies and groups to deliver many of those decisions. This is born out in our own work with partners the CAB and our ‘advice sessions’ more recently and indeed through the development of our own volunteer network.

We have spent many years driving forward our Landscaping project and aspirations, working closely with our partners the Parks Trust and City Council. Yet, at the eleventh hour, MKCC decided the new delivery ‘model’ under consideration could not be delivered under its own procurement regulations. Disappointingly, therefore, we now have to re-think and consider this project and are holding further conversations at this time to see what other options are viable. We are also planning a Parish meeting on the 20th June where there will be opportunities for residents to ask their own questions to MKCC Officers and also share other relevant community information at this time.

On a much more positive note, MKCC’s review of the Woughton Conservation Area has been completed. The first designation was made in 1978 and so was very much overdue for review. Our centre pages show the revised boundaries with some interesting additional areas taken in, which very much lie at the heart of Woughton’s heritage and historical ‘story’ and are significant to the landscape. Do follow the links shown for further detail as well as information on the New Town Heritage Register which is currently being compiled. A year ago, we were preparing for the Platinum Jubilee of the late Queen Her Majesty Elizabeth II, a momentous historical event in anyone’s lifetime, and now we look to celebrate the Coronation of King Charles III. Who would have thought....?

.. Our events steering group has been busy so do please take time to look on the back page (8.) for further information on our whole parish Coronation event on Bank Holiday Monday - 8th May 2023 (2-5pm). This will be a lovely opportunity to come together again as a community, chat with friends and neighbours and share a cake or two. And most importantly bring a little cheer in these challenging times - I look very much forward to seeing you there!.....

... I wonder if I could just slip in a marmalade sandwich or two...

Charlotte

Woughton on the Green Conservation Area

Woughton is one of several villages and hamlets that lay within the rural landscape of North Buckinghamshire prior to the creation of the new city. From the 1970s onwards it was realised that the unique charm of these small rural settlements was valuable with the potential to add positively to the experience of living in the new city which would be created around them.

A new planning tool, conservation area designation, was used as a means of assessing, acknowledging, establishing and managing areas deemed to be of special architectural or historic significance. The prevailing rural character of the villages and hamlets that lay within the emerging New City's boundaries would be protected by a requirement for planning decisions to pay special attention to ensuring proposed development would preserve or enhance local distinctiveness and an individual sense of place. The Woughton on the Green Conservation Area was originally designated in 1978.

Over time, there will inevitably be occasions where, for reasons of over-riding wider public benefit, development that does not preserve or enhance local character will be granted planning permission. This means that despite the weight of most debates tending towards positive outcomes there will sometimes be changes to places that contradict the prevailing character. New development may not always respect the conservation area boundary that was once deemed to denote an area of special character. Sometimes features are newly recognised as being of significance but lie just outside the designated area or the contribution to a place not specifically mentioned.

Creation and management of conservation areas rests with the local planning authority who must also review how their management of conservation areas has succeeded in protecting the architectural or historic character of a place. It is important to act on new information so that places not previously recognised of being of significance can be considered for inclusion or their contribution to significance explained. This process is called a conservation area review. Where new development has been permitted even where it might harm the character of a place or straddles a boundary the review process allows for the boundary to be redrawn.

Woughton on the Green Conservation Area



- Bridge 89 as it is now



- Bridge 89 before being rebuilt in 1918



The city-wide review process is now about half-way through (there are 27 Conservation areas); Woughton was completed early last year, and a new boundary adopted in March 2022. Important trees and woodland and open spaces were recognised alongside important buildings on the map shown here.

Newly included in the conservation area are the canal bridges:

Peartree Bridge (no. 88) a simple but robust red brick structure and the elegantly angled line of ‘Green Bridge’ (no. 89), built of dark engineering brick that replaced an earlier more rudimentary bridge (*see pictures*).

Also recognised in this review is The Old Rectory at Peartree Bridge. This Victorian House occupies the site of the former manor house and is surrounded by a moat (which was in part utilised for the construction of the canal in the early 1800s) and has its own Scheduled Ancient Monument listing.

For further information and details see:

<https://www.milton-keynes.gov.uk/planning-and-building/conservation-and-archaeology/conservation-areas-milton-keynes>

Martin Ellison - Senior Conservation Officer MKCC

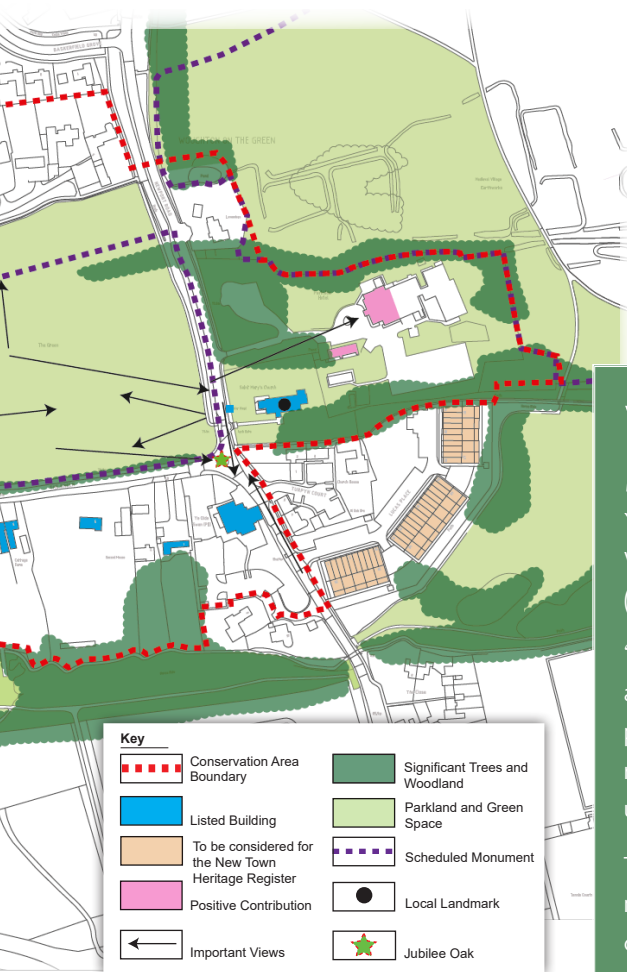

What does Scheduled Ancient Monument Listing mean?

You will note on the map that as well as the Conservation Area boundary, the Woughton on the Green and Old Rectory Scheduled Ancient Monuments are shown (purple boundaries).

‘Scheduling’ is the selection and listing of nationally important archaeological sites and is the oldest form of heritage protection. All ‘works’ (including gardening, ploughing, excavation, banging in pegs/posts etc.) to a scheduled monument requires consent from the Secretary of State for Digital, Culture, Media and Sport unless exempt. Carrying out work without permissions is a criminal offence.

There is a presumption underpinning the Listing that the Monument will be maintained for future generations without change. There are currently in the region of 20,000 monuments listed in England.

Milton Keynes New Town Heritage Register (MKNTHR)

The MKNTHR is a local initiative celebrating the distinctiveness of MK’s new town character. Technically ‘non-designated heritage assets’ in UK planning policy, the city’s residents have been asked to nominate assets for protection in the following categories: a building, structure and/or landscape completed within MKDC’s designated area between 1967-1992.

More than 250 nominations have been received by MK City Council. The first tranche includes the following around Old Woughton: **HR084** The Canal Broadwalk and associated Lombardy poplars. **HR217** Woughton - Lucas Place. **HR218** Woughton - Pavilion and Depot (Newport Rd). **HR231** Chaffron Way Grid Road (Marlborough St to Brickhill St)

A decision is expected from a specialist panel during 2023.

Census 2021

The 21st of March 2021 was Census night in the UK and we were all taking part in the once a decade population count. The results are emerging now and here are some highlights of what we collectively said in Milton Keynes:

Topic	2011	2021
Population of Milton Keynes (borough area)	248,800	287,100
Average (median) age	35 years	37 years
Largest age group: 35-49 years	22.7%	22.9%
Largest group by country of birth: England	78.1%	71.8%
Largest group by ethnicity: white	80%	71.8%
Largest group by religion: Christian	52.8%	42.8%
Largest group by housing tenure: owns/buying	57.7%	54.8%
Largest group by self-reported health: very good	44.9%	47.4%



Age profile

Old Woughton Parish (England)

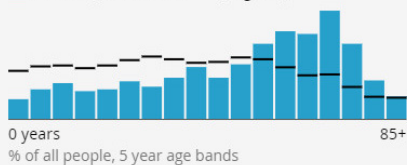

Population of Old Woughton Parish area 870 (rounded)

For the complete range of local area data go to:

<https://www.ons.gov.uk/visualisations/customprofiles/draw/> and enter "Old Woughton" in the find area box.

May Elections

MK City Council elections – 4th May 2023

Campaigning is already underway for this year's local elections, where one third of MKCC's seats will be up for election, including one in our ward of Campbell Park & Old Woughton. As usual, the Polling Station will be at St. Mary's church between the hours 07.00am-10.00pm or you can apply for a postal vote.

To apply for a postal vote you need to download and complete the register to vote by post form, which can be downloaded from here <https://www.gov.uk/government/publications/apply-for-a-postal-vote>, and return it to the Milton Keynes Election office. It can also be scanned and e-mailed to postal.votes@milton-keynes.gov.uk.

If you have any questions you can ring **MKCC** on **01908 254706**. Please do take part.

New Parliamentary boundaries

The work of the Boundary Commission for England is now drawing to a close on the 2023 review and initial proposals have been modified by a further round of public consultations. The continuing growth of MK has confirmed the need for a third seat for our city to be known as Buckingham & Bletchley. There is also a Milton Keynes North proposal, and Old Woughton parish will fall wholly in Milton Keynes South. These proposals will be put before Parliament by 1 July 2023.

At the time of writing, it is expected that these new arrangements will be in place in time for the next General Election.

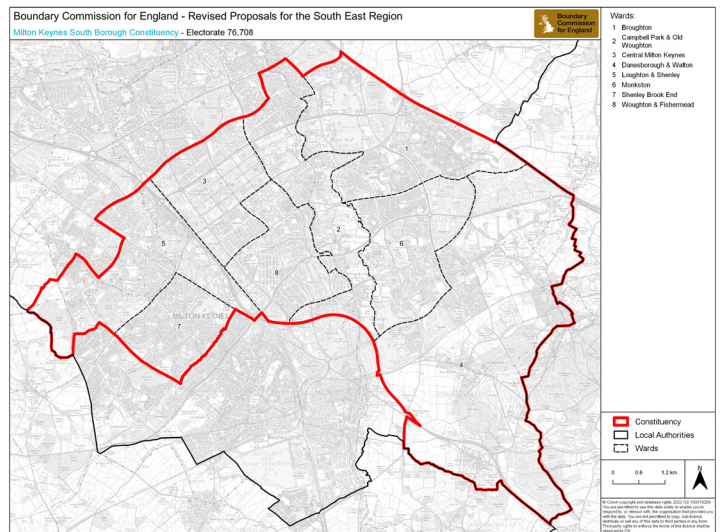

Voter ID – new requirements

The UK Government has introduced a requirement for voters to show photo ID when voting at a polling station at some elections. This new requirement will apply for the first time in England at the local elections on Thursday 4 May 2023.

Which forms of ID can I use to vote?

You may already have a form of photo ID that is acceptable. You can use any of the following:

- Passport
- Driving licence (including provisional license)
- Blue badge
- Certain concessionary travel cards
- Identity card with PASS mark (Proof of Age Standards Scheme)
- Biometric Immigration document
- Defence identity card
- Certain national identity cards

For more information on which forms of photo ID will be accepted, visit electoralcommission.org.uk/voterID or call their helpline on **0800 328 0280**.

Wheelie Bin Roll Out

Update as at March 2023

At the start of September 2023 the new MKCC waste collection arrangements will commence. See below some key information:

- A 'Post Code (address) Checker' will be available to see what arrangements are in place for each household.
- During the summer all households will receive correspondence on this matter.
- Bins will start to be delivered from June 2023 onwards. A small number of properties will remain on a sack collection service (coloured sacks will be distributed appropriately (Not black sacks))
- Start date 4/9/23 – 3 new bins will be introduced (Black, blue and red)
- Assisted Collections are available for those who meet the necessary criteria (disability or medical condition or nobody else in the household that put our waste). To see how to apply for this service see details on adjacent poster.

Weekly collections will continue for the Black (Non-recyclable

waste) and Green (Food and Garden waste) with Red (Paper and Cardboard) and Blue (Plastic, metal and glass) collected on alternate weeks.

For further information and updates as they happen visit :

<https://www.milton-keynes.gov.uk/waste-and-recycling/new-waste-collection-service-2023>.

If you don't have an accepted form of photo ID

If you don't already have an accepted form of photo ID, or you're not sure whether your photo ID still looks like you, you can apply for a free voter ID document, known as a **Voter Authority Certificate**. You can apply for this at voter-authority-certificate.service.gov.uk.

Alternatively, you can complete a paper application form and send this to the electoral services team at your local council. If you need any help with applying for a Voter Authority Certificate or want to request an application form, contact your local council. To find their contact details visit electoralcommission.org.uk/voter.

Find out more

If you have any questions or would like to find out more, go to electoralcommission.org.uk/voterID, or call their helpline on **0800 328 0280**.



Assisted collections

You may be eligible for help with your waste collection

If you have a disability or medical condition and there is nobody else in your household who can put your bags and bins out, you may be eligible for an assisted collection. *

We can arrange for our collection crew to collect your bags and bins from just outside your front door instead of the boundary.

How do I apply?

Please contact our Customer Services team by email customerservices@milton-keynes.gov.uk or telephone **01908 252570** to request an application form.

*We may ask for a proof of disability, such as an allowance, pension, or your disabled registration number.

www.milton-keynes.gov.uk/waste-and-recycling

MK Milton Keynes
City Council



WOUGHTON ON THE GREEN BOOK STOP

Parishioners have been enquiring about the conversion of one of the parish's redundant bus shelters for book lending and, in particular the choice of venue outside of the village. Despite this, generous donations of reading material are being made for avid readers.

Regrettably, OWPC was not consulted about this MK City Council initiative, so if you have any queries please contact the MKCC Strategic lead for Transport: adele.wearing@milton-keynes.gov.uk.

You now need
photo ID to vote at
a polling station

The
Electoral
Commission

Find out more at

electoralcommission.org.uk/voterID

No ID? You can apply for free voter ID

MK Citizens Advice Surgery

In December, OWPC dropped a flyer through your door advertising two advice sessions in the parish to help neighbours with cost of living concerns, in particular. All interviews were completely confidential and no appointments were necessary.

The first session ran at St. Mary's on January 21st between 10.30-13.30 and the Advisor was busy for the whole time, including receiving an invitation to address the MK Reader Service for those with visual impairments. Nice networking there. The second session was hosted free of charge on February 23rd by MK Dons SET, as our new operators of the Pavilion – thank you Delia and John! Again, the three hour session was fully taken up including some neighbours returning from the first session with progress to report, which was good to know.

OWPC will now consider Citizens Advice's feedback report and make a decision about the need for further sessions, but we already know that with the no.18 bus service suspended there was much appreciation for such a well-regarded service being brought into Old Woughton. If you have any views about this initiative going forward then please do drop a line to the Comms. Team. Thank you!



Old Woughton CORONATION THE BIG HELP OUT

SAVE THE DATE: Bank Holiday MONDAY 8th MAY



- Some of our local groups:
- Patch Allotments
 - St Mary's bell ringers
 - Churchyard gardeners
 - Scouts
 - Woughton Art Group
 - Woughton Heritage
 - Woughton walking group
 - Volunteer litter pickers
 - Speed watch
 - Canal volunteers

Live Music!

Venue:

Woughton House
(Hotel Grounds)

**Come along, join the celebration and find out more
about our local volunteer groups**

MONDAY 8th MAY 2 - 5pm

Invite neighbours



bring friends

Cream Teas provided

Bring your own drinks

Bake a Coronation Cake to share

all welcome

EVENTS

5th April - The Parks Trust Easter Eggstravaganza

10am – 12pm, Oakgrove,
(details here <https://www.theparkstrust.com/events/easter-eggstravaganza>)

22nd April - Litter Pick

10:30 – 11:30am, Woughton-on-the-Green South
(meet opposite pub)

1st May - MK Marathon Weekend

20th May - Litter Pick

10:30 – 11:30am, Woughton-on-the-Green North
(meet in the north Newport Road car park)

20th June - Annual Parish Meeting

6.30pm, St. Mary's Church

9th September - Woughton Heritage Quiz

7 – 10pm, St. Mary's Church
(Places available via woughtonheritage@gmail.com)

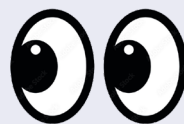

SEE A PROBLEM, REPORT IT

Old Woughton Parish Council (OWPC) are pleased to announce that we will be putting stickers on our dog and litter bins. This will identify the bins we own and manage and include a unique number.

Whilst our contractor endeavours to report any issue to us, there are occasions when something might happen outside their weekly rounds.



If you would like to view an electronic copy of the newsletter just scan the code

Old Woughton News is produced by

bespokemedia

design - print - distribution

t 01234 720105 m 07879 403 538 www.bespokemedia.org